



Herstellerausrüstung
manufacturers' equipments



Absperrklappen für die Lebensmittelindustrie in Edelstahl AISI 304

Butterfly valve for foodstuffs in AISI 304 stainless steel

Absperrklappe
Butterfly valve

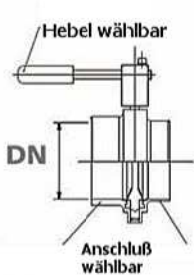

DN -25
-32
-40
-50
-60
-65
-80
-100

Anschlußtypen
Connection types



Gas M
BPS Male thread

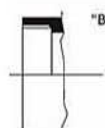

Gas F
BPS Female thread

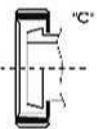

DIN M mit Gewinde
DIN 11851 conical Coupling with nut



DIN F
DIN 11851 threaded Coupling

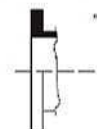

Flansch
Flange



Triclamp
Garolla



Schweißen
Welding

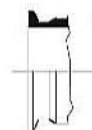

Klammer
Clamp

Klappe
Closure plate



DN	Code
80	A37080
100	A370

Hauptdichtung
Main seal



DN	Code
80	A36680
100	A36615
100	A366 /SILICON

Anschweißflansch
Welding flange



DN	Artikel Code
80	A37280
100	A372

Hebel
"C"



Artikel Code
A369L

Dichtung
Gasket



DN	Artikel Code
80	A37380
100	A373

PTFE + esenteamianto
PTFE + asbestos free

Zughebel
"D"



Artikel Code
A369